

Wide Spray Coverage

at low water pressure

Clog-resistant Wide-angle Full Cone Spray Nozzles

UZUJP series

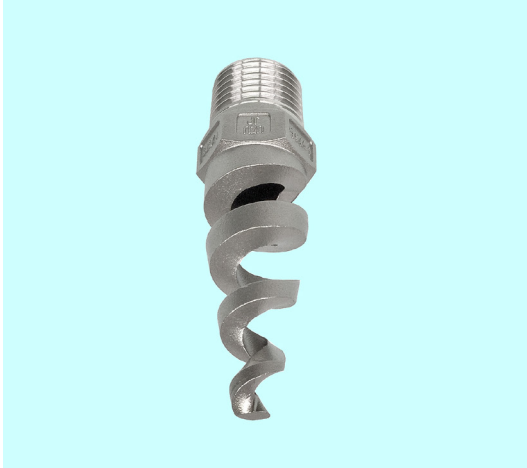

Features

- Spray covers a large area even at a low water pressure.
- Required nozzle quantity is minimized, and system installation cost is lowered.
- No-whirler design produces a large spray capacity for a compact size and minimizes clogging.

Applications

- Fire extinguishing, spraying (Coal tower at steel mills, conveyor belt, and more)
- Exhaust gas cleaning and cooling
- Dust suppression
- Applications where clogging is a concern

Dimensions and mass

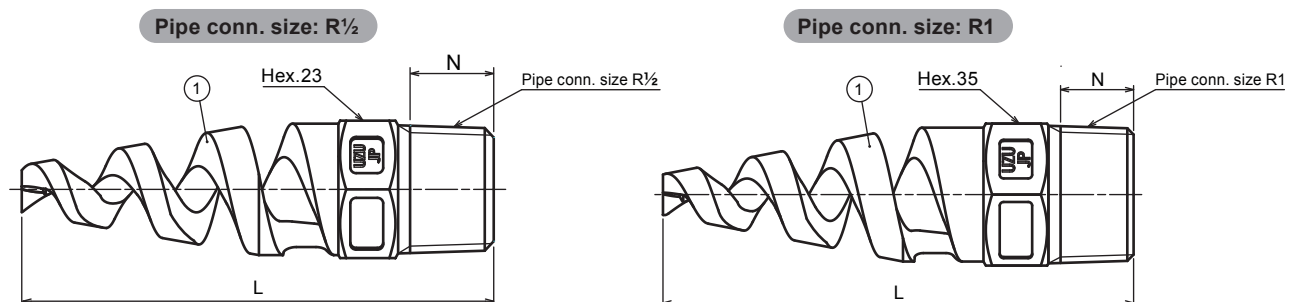

① Nozzle (SCS16*)

Pipe connection sizes	Dimensions (mm)		Mass (g)
	N	L	
R $\frac{1}{2}$	14	79	Approx. 80
R1	18	116	Approx. 250

*Cast stainless steel equivalent to S316L.

Note: Optional cap can be added upon request.

Flow-rate diagrams

■ UZUJP17075

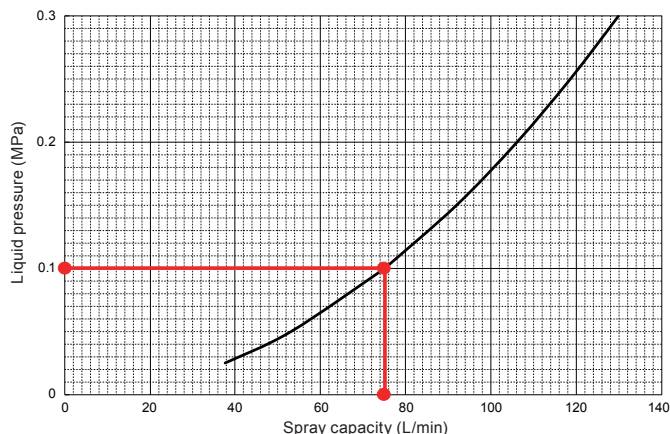

■ UZUJP170100

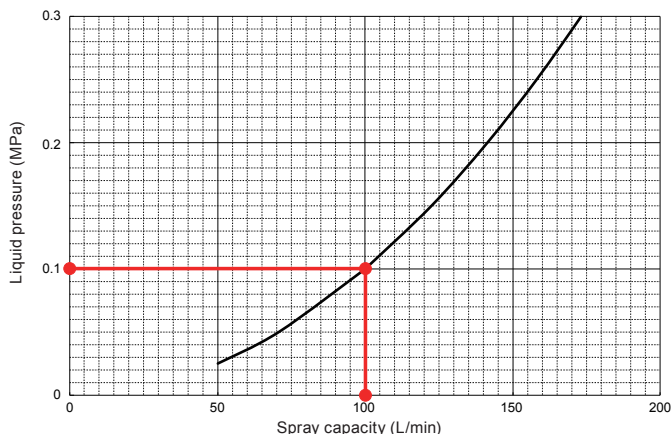

■ UZUJP170220

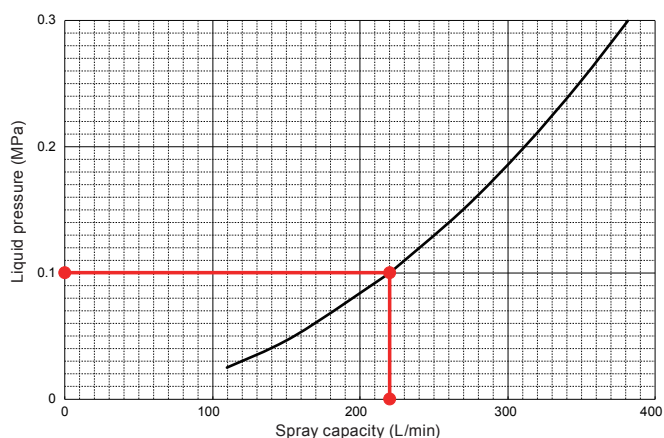

Specifications

Spray angle code	Spray capacity code	Pipe conn. size	Spray angle (°)				Spray capacity (L/min)					Free passage diameter (mm)
			0.03 MPa	0.05 MPa	0.1 MPa	0.3 MPa	0.03 MPa	0.05 MPa	0.1 MPa	0.2 MPa	0.3 MPa	
120	75	R½	109	120	120	120	41.1	53.0	75.0	106	130	4.3
	75	R½	159	167	170	170	41.1	53.0	75.0	106	130	5.0
170	100	R½	159	167	170	170	54.8	70.7	100	141	173	5.2
	220	R1	159	167	170	170	120	156	220	311	381	7.3

How to order

Please inquire or order for a specific nozzle using this coding system.

(Example) ½M UZUJP 17075 SCS16

½M **UZUJP** 170 75 **SCS16**
Pipe conn. size* Spray angle code Spray capacity code
½M 120 75
1M 170 100
1M 170 220

*"M" indicates male thread ("R" of the ISO standard) and "F" indicates female thread ("Rc" of the ISO standard), e.g. 1/2M = R1/2.

Specifications, contents, and appearance of this product and leaflet are subject to change without prior notice for purpose of product improvement.

Please feel free to send any inquiry, request for information or quote on this product to the contacts below.

Headquarters



"The Fog Engineers"
H. IKEUCHI & CO., LTD.
いけうち

Daiichi Kyogyo Bldg., 1-15-15, Awaza, Nishi-ku, Osaka 550-0011, Japan
 Tel: 81-6-6538-4015 Fax: 81-6-6538-4022
 E-mail: overseas@kirinoikeuchi.co.jp
 URL: <https://www.kirinoikeuchi.co.jp/eng/>

We have our branches and affiliate companies around the world—in China, USA, The Netherlands, Turkey, Thailand, Indonesia, UAE, and more. Please see our website for the nearest contact.

<https://www.kirinoikeuchi.co.jp/eng/company/location/>