

For blowers

Flat Type

FEATURES

- Air nozzle with a 42 mm wide even jet.
- Blower air nozzles, **reducing energy cost to one-third** of that for compressed air driven nozzles.
- Unique design combining air-amplification, even air flow distribution, and low-noise capabilities.

Flat Type



Plastic TF-BF



Material: ABS
 Mass: 26 g
 Max. air pressure: 100 kPa (14 psi)
 Max. allowable temperature: 80°C (170°F)

Metal TF-BF



Material: Aluminum A5052
 Mass: 65 g
 Max. air pressure: 100 kPa (14 psi)
 Max. allowable temperature: 316°C (600°F)

Dimensions

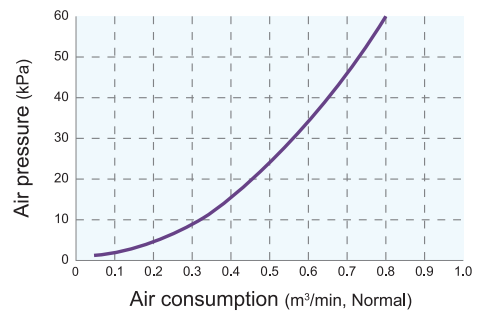
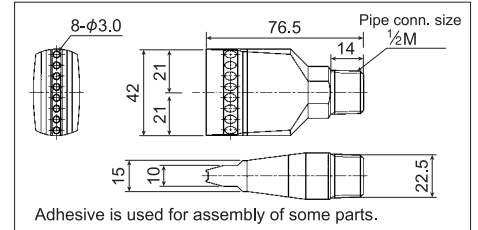

For blowers

Round Type

FEATURES

- Blower air nozzles, **reducing energy cost to one-third** of that for compressed air driven nozzles.
- Unique design combining air-amplification, even air flow distribution, and low-noise capabilities.

Round Type



Plastic TF-BR



Material: ABS
 Mass: 8 g
 Max. air pressure: 100 kPa (14 psi)
 Max. allowable temperature: 80°C (170°F)

Metal TF-BR



Material: Aluminum A5052
 Mass: 20 g
 Max. air pressure: 100 kPa (14 psi)
 Max. allowable temperature: 400°C (750°F)

Dimensions

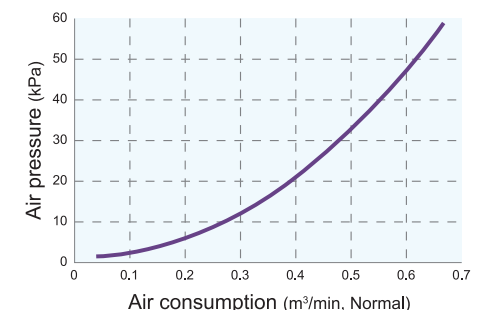
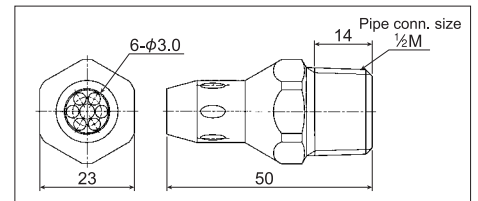

► Air nozzle with pinpoint aim for gaps and narrow spaces.

How to order

Please inquire or order for a specific nozzle using these product codes (select material).

Flat Type

<Example> 1/2M TF-BF 42-8-030 ABS
1/2M TF-BF 42-8-030 ABS

Material
 ■ ABS
 ■ A5052

Round Type

<Example> 1/2M TF-BR 6-030 ABS
1/2M TF-BR 6-030 ABS

Material
 ■ ABS
 ■ A5052